

BUSINESS CENTER



The most anticipated trade show in our industry!!!

This year, the Business Center is located inside the Aventine Ballroom and is again right in the center of the action!
Combine that with exclusive trade show hours and you have **MAXIMUM EXPOSURE**

*****REMEMBER TO RESERVE EARLY AS WE ALWAYS SELL OUT QUICKLY*****

HOURS OF OPERATION

Wednesday, February 23rd

Set-up 8:00 a.m. – 4:00 p.m.

Thursday, February 24th

8:30 a.m. – 4:00 p.m.

5:00 p.m. – 6:00 p.m.

Friday, February 25th

10:00 a.m. – 12:00 p.m.

Saturday, February 26th

10:00 a.m. – 12:00 p.m.

Tear Down 12:00 p.m. – 2:00 p.m.

(tear down must be completed by 2:00 p.m.)

Specs & Pricing

Standard Booth 8'x8' = \$450

Includes 1 six foot draped table & 2 chairs

Double Booth 8'x16' = \$800

Includes 2 six foot draped tables &
4 chairs

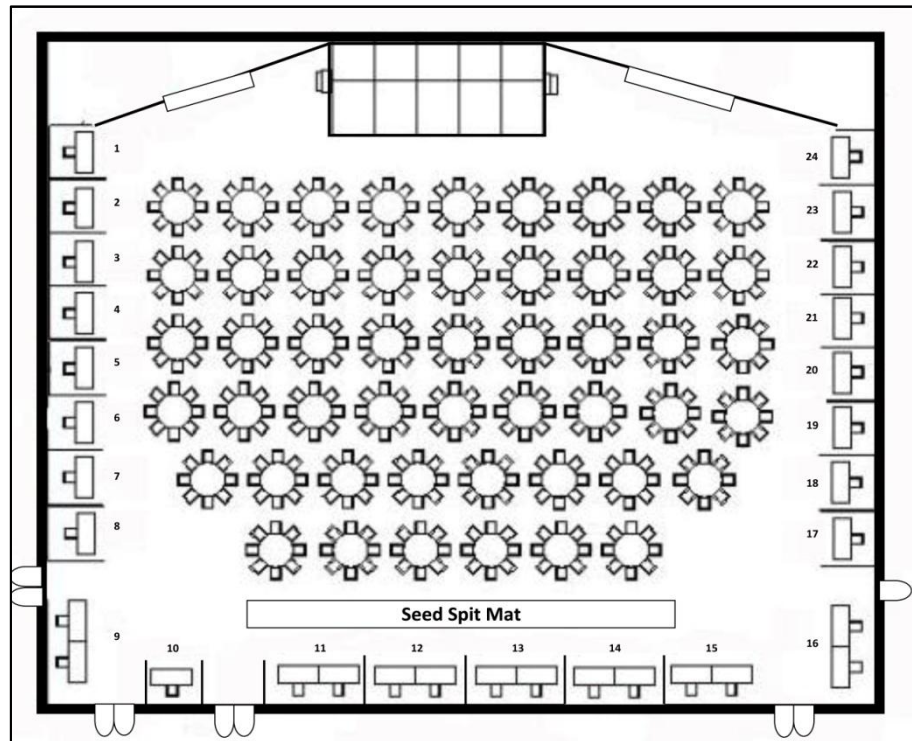

BOOTH LOCATIONS

Locations are subject to availability and will be assigned on a first come first serve basis.

DEADLINE FOR BOOTH REGISTRATION IS 2/1/2011 or until sold out!

A larger pictorial can be found on the NWA Website

BOOTH FEES **DO NOT** INCLUDE CONVENTION ADMITTANCE

REGISTRATION MUST BE PURCHASED SEPARATELY